

LEGEND

- PROPOSED ROADWAY
- PROPOSED FOOTPATH
- PROPOSED PEDESTRIAN/CYCLEWAY
- PROPOSED SHARED SURFACE
- PROPOSED VERGE
- PROPOSED EMBANKMENT
- PROPOSED SITE COMPOUND AREA
- PROPOSED DRAINAGE NETWORK
- PROPOSED OVER THE EDGE DITCH
- EXISTING DRAINAGE SIPHON
- PROPOSED DRAINAGE ATTENUATION
- PROPOSED CROSSING PIPE
- SITE PLAN OUTLINE
- STONE WALL MINIMUM 2.5m
- WALL & RAILINGS
- BOUNDARY WALL MINIMUM 2.5m
- 2.0m NOISE BARRIER
- 2.5m NOISE BARRIER
- 3.0m NOISE BARRIER

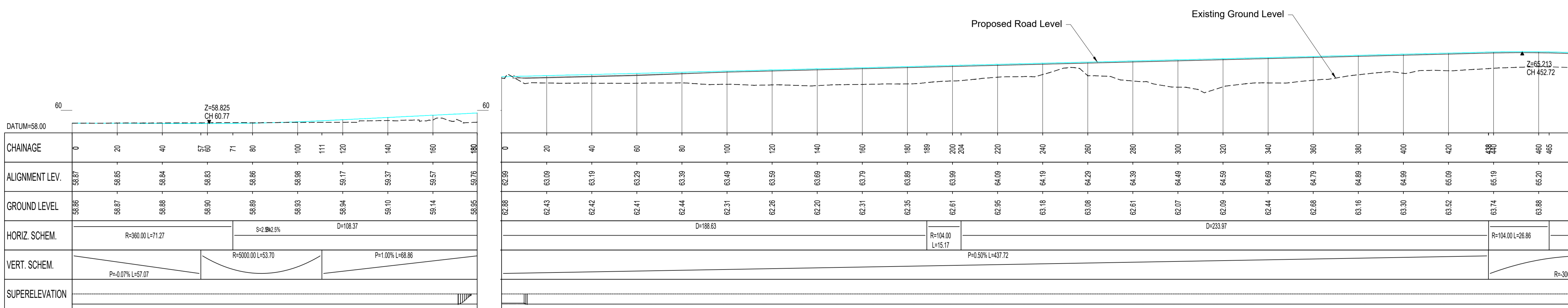

ROAD NAME: Griffin Rath Manor

ROAD NAME: Maynooth Eastern Ring Road

Roads Transportation and Public Safety Dept.
Roads Design Office

Director of Services - Mr Niall Morrissey
Senior Engineer - Mr. John Coppinger, BE, C Eng, MIEI.

Kildare County Council, Comhairle Chontae Cill Dara
Áras Chill Dara, Devoe Park, Naas, Co.Kildare
T:+353-45-980424 F:+353-45-980420 E: roads@kildarecoco.ie

No.	Revision	Date	By	Chkd	App'd
P01	Issued For Approval	29/03/2019	PC	IF	SMG
P02	Issued For Approval	29/04/2019	PC	IF	SMG

FROD
ROUGHAN & O'DONOVAN

Consulting Engineers
Civil - Structural - Transportation - Environmental

Arena House, Arena Road, Sandyford, Dublin 18, Ireland
t +353 (0) 1 294 0800
f +353 (0) 1 294 0820
www.rod.ie

Drawn	Designed	Checked	Approved	Suitability Code - Description
PC	IF	SMG	MK	S2 - Information/Planning

Project Stage	Part 8 Planning				
Project Title	Maynooth Eastern Ring Road				
Drawing Title	Proposed Layout Plan & Profile Sheet 1 of 3				
Project Number	MERR	Originator	ROD	Volume	LSI
Location	SW_AE	Type	DR	Role	CH
Number	40201				
Scale (A1)	1:1000	Date:	May 2019	Job No:	18.109
Rev:	P02				